

TEXAS ARCHITECT





Above: Jones & Kell of San Antonio organized the office and product-display space in the client's existing warehouse building by creating an elliptical area around a skylit atrium. Office-systems furniture was used to respond to the fast-changing workload and staffing needs of the client, a sportswear manufacturer.



Right and facing page: Conference rooms open from the atrium.

Below: plan of the office/product-display area

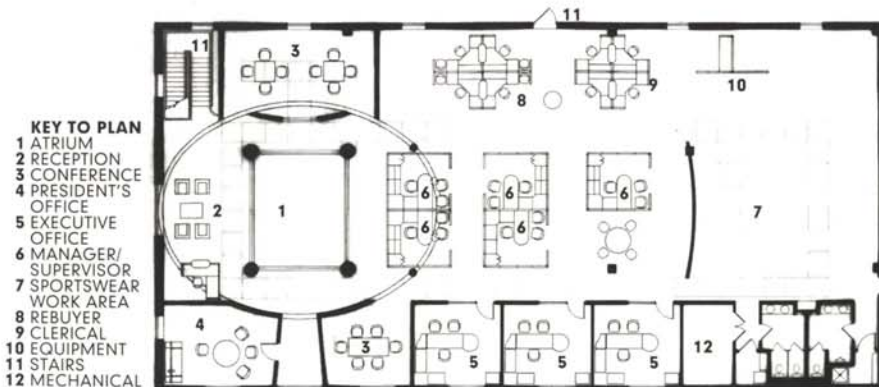

Sportswear Focus

Sunbelt Sportswear, San Antonio
Jones & Kell, Inc., San Antonio

JONES & KELL, INC., won one of three TSA Design Awards given in the category of interior architecture. What they had to work with was as architecturally unprepossessing as it gets: a 12,000-square-foot warehouse building in a San Antonio industrial park with a skylight and atrium and some massively scaled interior columns. What the architects produced from this is a textbook example of the unique value that design can bring to a standardized building.

The client wanted to turn a portion of its warehouse space into offices that were nicer than those typical of the warehouse building type. In addition, the client wanted to create an environment in which the company's clothing products could be shown to wholesalers and retailers, potential buyers for whom an atmosphere portraying efficient production and dependable turn-around would be more impressive than a glitzy showroom.

Jones & Kell set the new showroom space around the skylit atrium in an ellipse created in plan and elevation by shaping walls, columns, and flooring patterns. A monochrome color scheme was used to provide an optimum background for the display of the various sportswear lines. The architects joined the industrial and office functions in the space, exposing the mechanical, electrical, and plumbing services and making them part of the decor; highlighting the company's manufacturing operations by opening office windows to the manufacturing areas; and juxtaposing office-type finishes with industrial materials. Offices were kept flexible by the use of office-systems furniture, reflecting the changing workload and personnel level of the company.

JWB

PROJECT TEAM John H. Kell, Jr.; Steve Land Tillotson; Michael G. Imber; Thomas R. Jackson; Marsba Bruner; Reagan W. Coker

CLIENT Sunbelt Sportswear, San Antonio

CONTRACTOR Bartlett Coker, Jr., Construction Co., San Antonio

CONSULTANTS W.E. Simpson Co. (structural); James T.

Rodriguez Consulting Engineers (mechanical, electrical, and plumbing)

PHOTOGRAPHER R. Greg Hursley, Inc.

